

## Graifer forestier SP 182

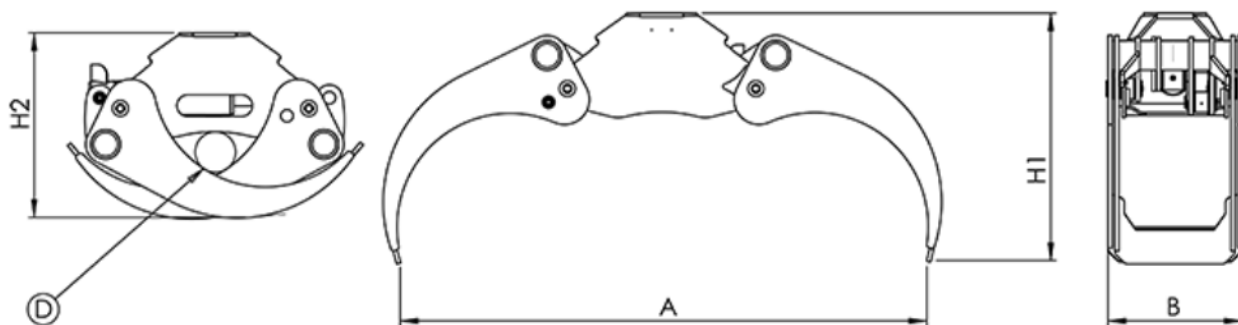

<b>Graifer forestier SP 182</b>	
Deschidere maxima - A	1820 mm
Latime – B	420 mm
Inaltime deschis – H1	805 mm
Inaltime inchis – H2	560 mm
Diametru minim de prindere - D	90 mm
Suprafata de prindere	0,37 m <sup>2</sup>
Presiune maxima admisa	230 bar
Capacitate de incarcare	5000 kg
Masa proprie	215kg

[www.forestprofi.com](http://www.forestprofi.com)

*Partenerul tau forestier !*