

**DIMENSIUNI**

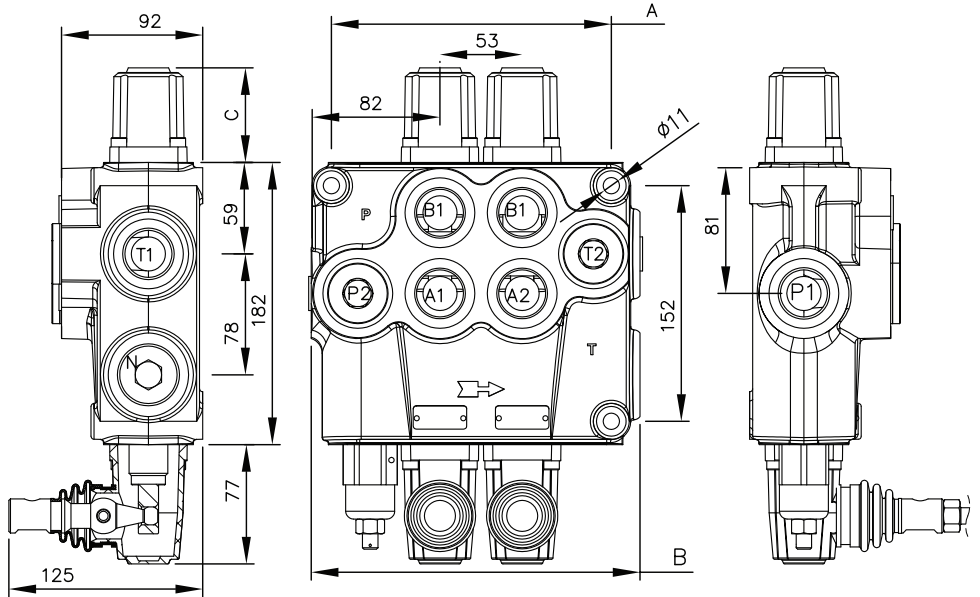

	V120 - 1	V120 - 2	V120 - 3	V120 - 4
A	129	182	235	288
B	160	213	266	319
C	64	64	64	64

CONTROL SERTAR	C
1 - 4 - 5 - 6 - 7 - 8 - 9 - 10 - 11	64
12	74

CODE	PORTURI DE LUCRU
11	P1 - T1
12	P1 - T2
21	P2 - T1
22	P2 - T2

CODE	PORTURI			
	P	A - B	T	N
M	M33x2	M33x2	M33x2	M33-1.5
G	1" BSPP	1" BSPP	1" BSPP	M33-1.5
S	15/16"-12 UNF	15/16"-12 UNF	15/16"-12 UNF	M36-1.5

**PERFORMANTE**

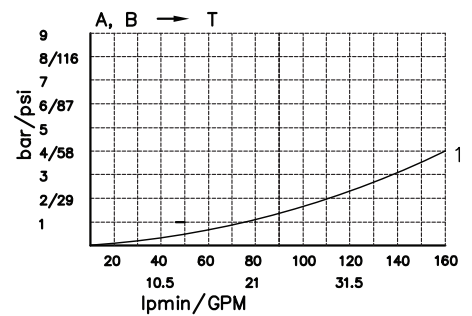
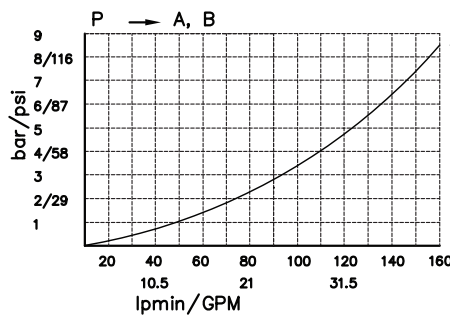
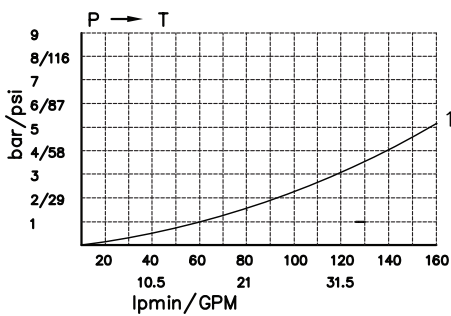

**SPECIFICATII**

SPECIFICATIE TEHNICA	UNITATE MASURA		SCURGEREA LA NIVELUL SERTARULUI LA 100 BARI (1450 PSI), TEMPERATURA DE 50°C (120°F) SI VASCOZITATE DE 27 cSt		
Debit maxim	L/min U.S.G.P.M.	120 32	Maxim	cm <sup>3</sup> /min cu.in/min	30 1.83
Presiune maxima de lucru	Bar PSI	300 4350	Mediu	cm <sup>3</sup> /min cu.in/min	20 1.22
Presiune de intoarcere	Bar PSI	50 700	Valorile minime la cerere		
Temperatura ulei	°C °F	-10 / 80 14 / 180	<b>NUMAR SERTARE</b>		<b>DELA 1 LA 4</b>
Vascozitate	°E cSt	2,4 / 10 16 / 75	Supapa reglabila de descarcare (limitare)		VP
Filtre ulei	μ	≤30	Supapa de inchidere		C

GREUTATE				
	V120 - 1	V120 - 2	V120 - 3	V120 - 4
Unitate masura	Kg / LBS			
Greutate	8 / 17.63	11 / 24.24	13 / 24.64	15 / 2.05

<ul style="list-style-type: none"> <li>- Corp - fonta cu rezistenta mare.</li> <li>- Sertar - otel calit si cromat.</li> <li>- Garnituri - buna "N".</li> <li>- Circuit paralel - tandem.</li> <li>- Sertare interschimbabile.</li> <li>- Selectie vasta a admisiiilor, porturilor de lucru si a evacuarii filetate.</li> <li>- Acoperirea negativa a sertarului.</li> </ul>	<b>Operatii:</b> <ul style="list-style-type: none"> <li>- Pozitie centrala deschisa sau inchisa, 3 sau 4 cai, centrul total deschis (sertarul de antrenare) si alte optiuni pentru sertar.</li> <li>- Ansamblu complet cu maneta.</li> <li>- Gama larga de pozitionari.</li> <li>- Bucla de siguranta</li> </ul>	<b>Simboluri:</b> <ul style="list-style-type: none"> <li>P- admisie; T- refluxare;</li> <li>A/B- porturi de lucru; H.P.C.O.- bucla de siguranta; VP- supapa de limitare a presiunii; P<sub>2</sub> T<sub>2</sub>- porturi de admisie/ refluxare superioare; P<sub>1</sub>- admisie laterala; P<sub>1</sub>- refluxare laterala; P- linie de presiune; T- linie de refluxare;</li> <li>N- by pass</li> </ul>
--	--	---



**REPREZENTAREA SERTARELOR**

Tip	Reprezentari sertare
A	
B	
C	
D	
E	
F	
G	
H	
M	
N	
O	
P	
Q	
R	
S	
T	
L	

Tip	Pozitionari sertare
1	
2	
3	
4	
5	
6	
7	
8	
9	
10	
11	
12	
13	

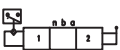
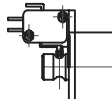

Tip	Optiunea microcomutator
17	 Microcomutator tip OMRON v165/C5 Control sertar 1 

**SCHEME**

Cod	Tip circuit
P	Paralel
T	Tandem

Cod	Supapa descarcare
W	Fara supapa de descarcare
V180	Cu supapa de descarcare - ajustare din fabrica la 180 de bari



Cod	Port refulare
X	Fara H.P.C.O.
C2	H.P.C.O. 1" BSPP filet pe gaura
N	Pre-aranjare al H.P.C.O.
C4	Centru inchis

Cod	Supapa de inchidere
S	Supapa de inchidere simpla pe portul de admisie
C	Supapa de inchidere pe fiecare sectiune

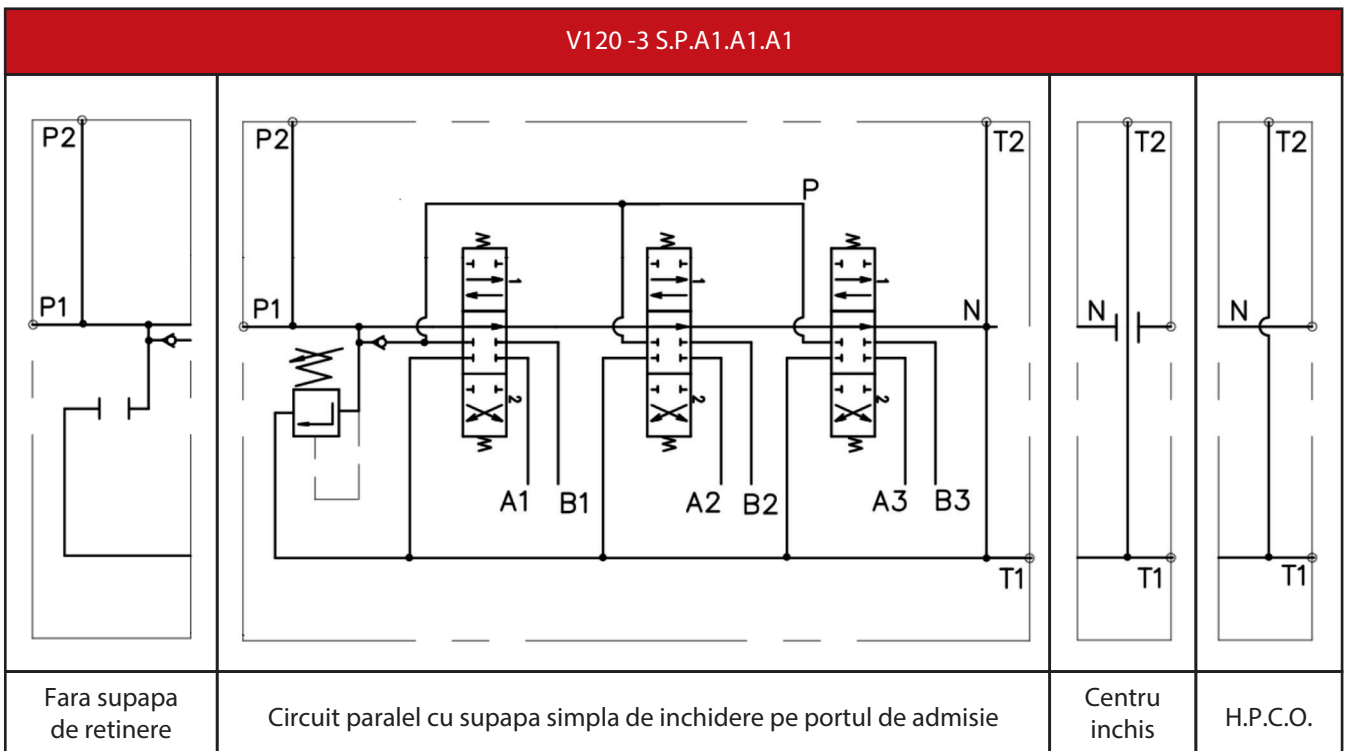
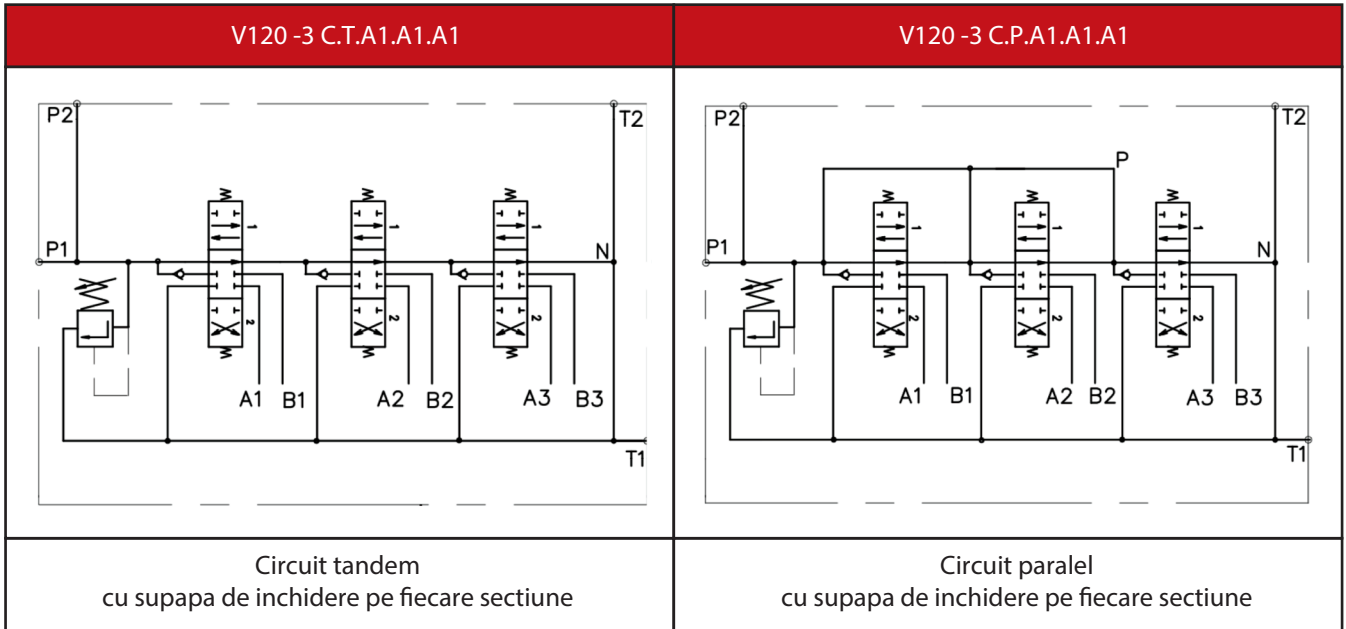
**SCHEME**

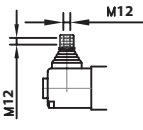
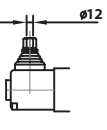
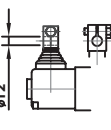

**CONTROL SERTAR**

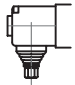
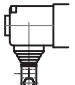
Cod	L10	L11	L12	L20	L21	L22
Caracteristica						
Descriere	Control maner	Control maner	Control maner	Control maner	Control maner	Control maner

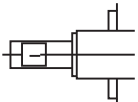
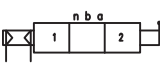
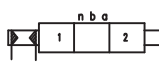
Cod	SL	P	H	TC	TP	M
Caracteristica						
Descriere	Fara control maner	Control pneumatic on/off 5-20 bari Port pilot 1/4" BSPP	Control hidraulic on/off 5-20 bari Port pilot 1/4" BSPP	Telecomanda cu cablu	Telecomanda cu cablu	Control Joystick

**TELECOMANDA CU CABLU**

Maner			
Cod	3047	3076	3077
Cursa	13 + 13 mm	13 + 13 mm	13 + 13 mm
Incarcare maxima	45 Kg	45 Kg	45 Kg
Raport nivel	10 : 1	10 : 1	10 : 1
Blocare in centru	nu	nu	nu
Blocare antirevers	nu	da	nu
Culoare corp	negru	negru	negru
Tip cabluri	de rezistenta mare	de rezistenta mare	de rezistenta mare
Temperatura de lucru	-80 / +80°C	-80 / +80°C	-80 / +80°C

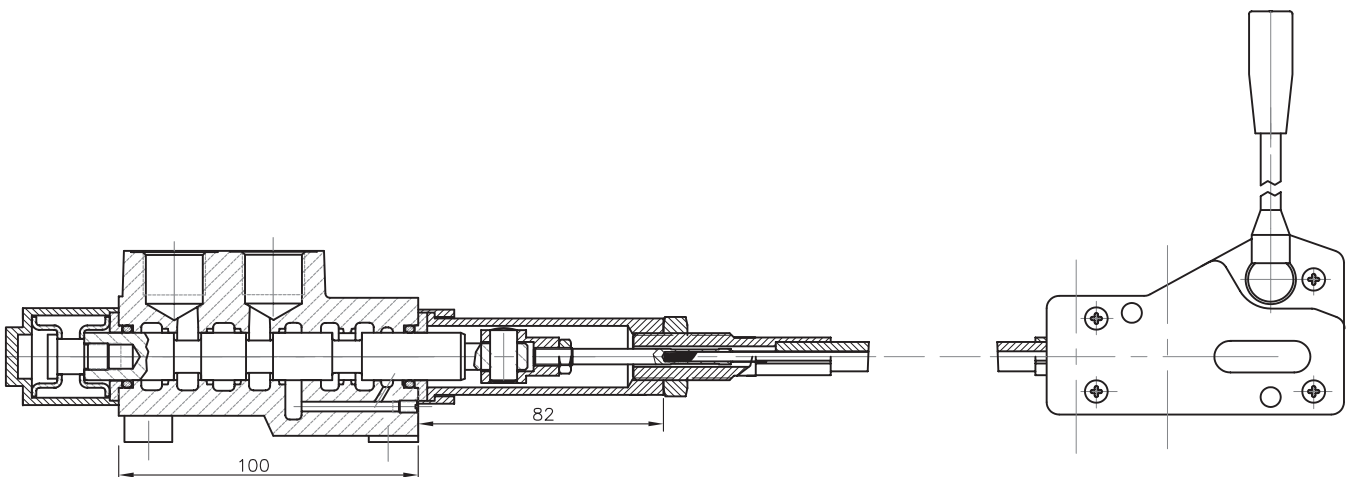

**CONTROL JOYSTICK**

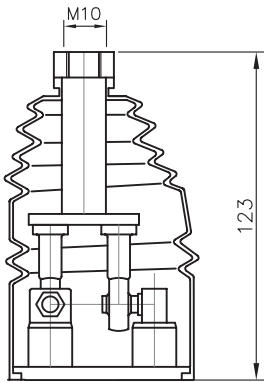

Versiune standard 1

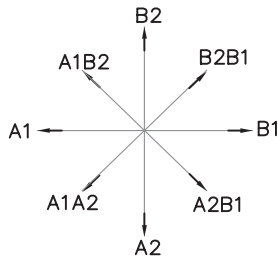
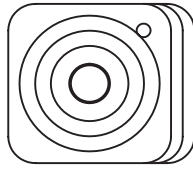

Versiune standard 2

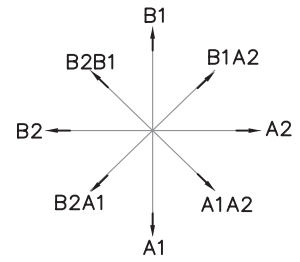
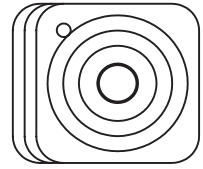

Versiune standard 3

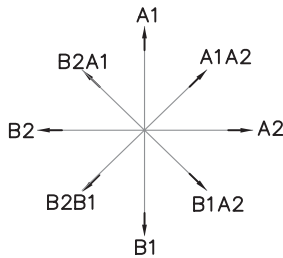
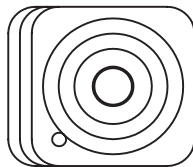

Versiune standard 4

